

# INSTALLATION AND OPERATION MANUAL

# ADVISION

## AD-500S

On Wall Amplifier with USB/FM & Bluetooth

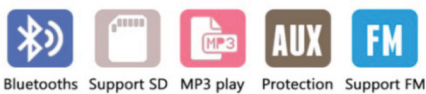

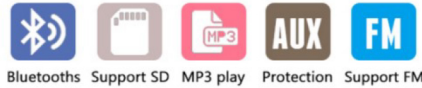

### Feature:

- Stereo amplifier in-wall system with 2 ceiling speakers
- 2x 15W Class-D digital amplifier
- Built-in media players includes blue tooth Streaming, FM radio, USB, microSD card and line level AUX
- 2x 5" low profile 15 watts ceiling speaker with superior Hi-Fi sound performance
- Touch sensitive panel with English display
- Including back box, 10m cable and a remote control

### Description:

The A5D In-Wall Amplifier & Ceiling Speaker Set consists of a music system (Wireless In-wall controller) with a built-in amplifier, a Mp3 FM Bluetooth media player and multiple pieces of ceiling speakers with superior sound performance. The sleek elegant finish with a touch sensitive panel provides a minimalist look, so your sound is heard and not seen. All cables and connections are securely hidden within the walls out of sight with no tripping hazards. Enjoy your favourite music from many sources, such as BT Streaming, FM radio, USB, microSD card and line level AUX. The BT streaming function allows you to connect directly to your smart phone, tablet, laptop, etc. The touch screen gives you the ability to control all aspects of the system, simply touch and go. It's also possible to use the included remote control. The In-Wall Amplifier & Ceiling Speaker Set includes high quality 5" 15W ceiling speakers are equipped with a metal flush fitting grille with easy mount in-ceiling installation. Ideal for use in your living room, veranda, garage, showroom, restaurant etc. A complete and versatile audio solution for wall or ceiling background music speakers in the home or commercial audio applications.

### Specification:

Model	A5D
Description	In-Wall Amplifier & Ceiling Speaker Set
Power Supply	100-240V AC, 50/60Hz (screw terminal)
Rated Power Output	2×15W@ 8 Ohms
Audio Format	mp3, wma, wav, flac, ape, dts, aac, ac3, ogg
Video Format	Mpeg-1/2/3/4, rm/rmvp, wmv, mov, mk, vob, avi, 3gp, h.264
FM Range	87.5-108mHz
Distance	IR remote control & Bluetooth distance up 20 meters
Frequency Response	20Hz~20KHz (at±0.3dB)
THD	<0.03% at 1kHz, 1W
SN Ratio	>98dB
Volume	Bass: ±15dB; Treble: ±15dB
Display	2.8" English display, 320×240 resolution
Speaker Cutout	Ø 170mm
Mounting Dept	57mm (amplifier), 80mm (speaker)
Dimension	86 x 86 x 50mm (amplifier), 76 x 188mm Ø (each speaker)
Weight	152g (amplifier), 700g (each speaker)

## Preface

Thank you for selecting our company intelligent background music controller, all of products are through strict test, before they go out, the quality of word smart host background music controller is widely used in high-end residential, villas, senior clubs, hotels, and other places of music, is that you choose intelligent background music controller host's ideal choice, for the convenience of installation, debugging and use of this product, you auspicious fine, please read this manual before installing, debugging.

## Host function description:

1. Audio format: support MP3, WAV, WMA and other audio formats, support for LRC lyrics.
2. The radio function: built-in all-digital automatic FM radio, 30 radio stations.
3. Bluetooth function: support external Bluetooth devices such as mobile phones to achieve audio playback.
4. External sound input: support external audio input to the unit, and enlarge the output.
5. Setting function: support Chinese and English switching of the native language; set backlight brightness; set to restore factory settings;
6. Memory card function: extra TF card, support 32GB TF card.
7. OTG function: Connect the USB flash drive (supporting 32GB) through the USB interface to read music, and easily set up the family background music space.
8. A variety of loop playback mode: support single play, random play, sequential play, single loop, all loop play mode.
9. Volume adjustment: 27-level electronic volume adjustment function.
10. Power-off memory function: remember the state played before the last shutdown.
11. Infrared remote control function: provide a variety of shortcut keys and user-friendly operation.
12. Doorbell trigger: Support external trigger doorbell function.
13. Support for power-on playback.
14. Support linkage trigger to play the specified music.

## Product List:

List	Quantity	Remark
A5D	1	√
Manual	1	√
Warranty card	1	√
Screw	1	√
Mounting box	1	√
Remote controller	1	√
Hi-fi Ceiling Speaker	2	Optional
TF Storage card	1	Optional
Tuning Switch	1	Optional
Audio cable	1	Optional

## A5 Parameter:

AC Power	AC220V(50HZ) allow 110V-250V	Load	6-8ohm
Output Power	2x15W	S/N Ratio	≥98dB
Frequency response	87.5-108MHz	Infrared remote range	10M
Bluetooth Distance	10M	Dimension	86*86*10mm

LR Aux In	Two channels connecting strips	Input Sensitivity	0.775Vrms
IO Trigger	Short out trigger	Signal Mode	Passive dry contact signal

The company continues to improve product performance, design specifications are subject to change, subject to the real thing, without notice.

### Precautions

1. This host is suitable for AC110-250 power supply, please install and debug under the guidance of professionals.
2. Please read this manual carefully and follow the instructions for installation and operation.
3. Speaker cable, power cable, and audio source input cable. Please check the terminal carefully.
4. Confirm that all the cables are correct before turning on the power.
5. Do not modify, disassemble, or upgrade the host.
6. When not using the host for a long time, please turn off the main power switch.

Installation and disassembly of the host instructions:

1. Embedded box provides 86 bottom boxes with a bottom box depth of 57 mm.
2. The wire used in this product: multi-strand copper wire, coaxial wire, audio cable, audio cable.
3. Please consult the supplier when installing this unit.
4. Do not repair the machine without authorization. If you need to repair, please consult the supplier and be repaired by a professional.

Host installation instructions:

1. Tighten the bracket to the 86 cassette with the bracket screws. (as shown in Figure 1)
2. Tighten the wire inside the 86 cassette to the wiring of the corresponding function of the host, then insert the wiring rib into the terminal block, then load the main unit into the hardware bracket, and then push down. (as shown in Figure 2)

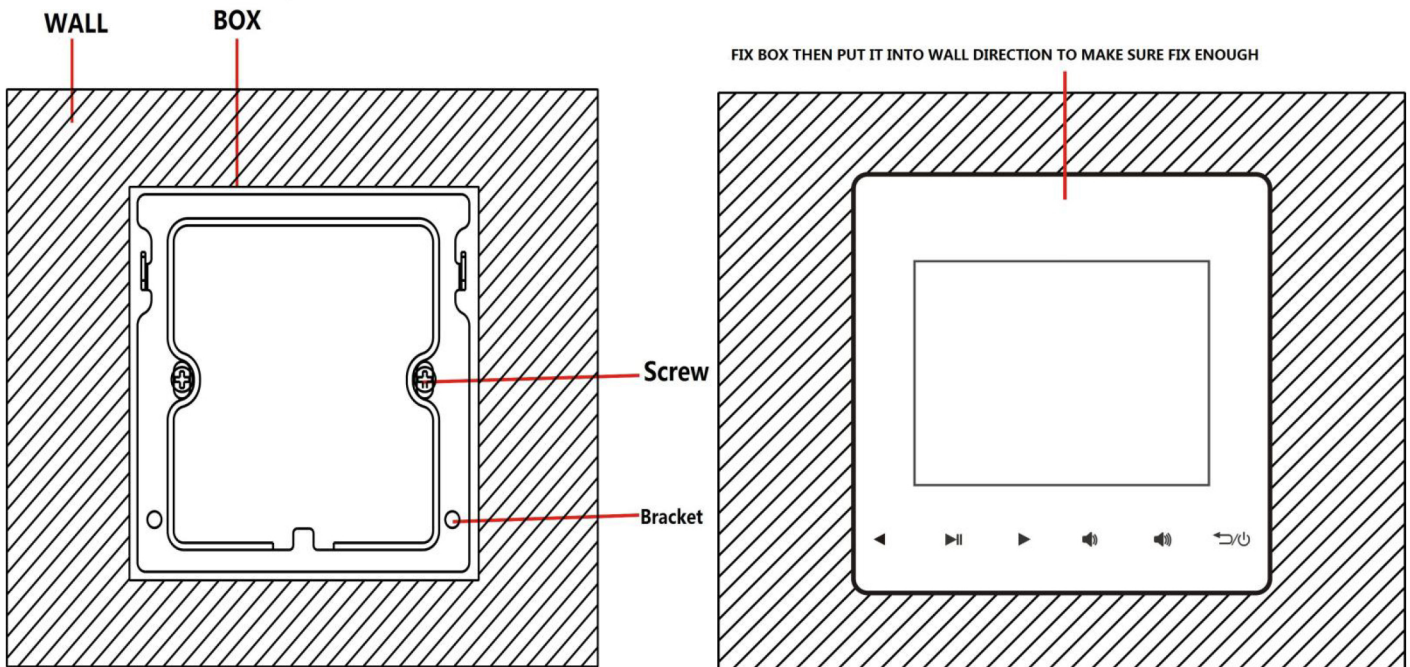

3. After the installation is complete, turn on the power switch button, you can boot.



## Connection

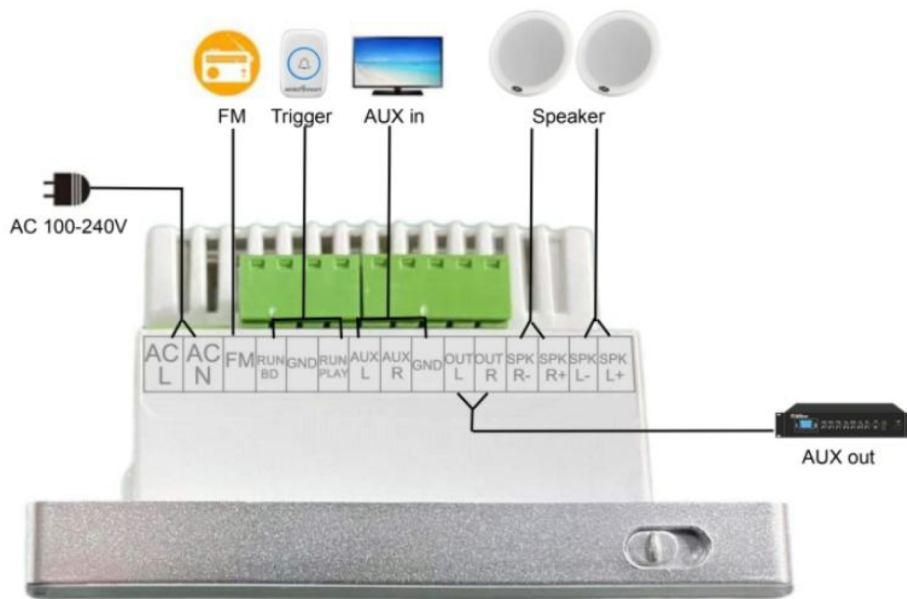

### Bottom Edge



- 1、 Power input line(AC L & AC N): Two copper core wires with a single copper core of 0.75 square or more.
- 2、 FM signal line: the use of a single strand, the core diameter is not less than 1mm, the length of more than 2 meters.
- 3、 IO control line 1 (trigger doorbell control line): two copper core wires, single strand copper core 0.75 square or more.
- 4、 IO control line 2 (trigger host standby control line): two copper core wires, single-strand copper core 0.75 square or more.
- 5、 AUX audio input: audio cable (two core shielded cable: commonly known as microphone cable), RVVP2X0.5, RVVP2X0.75. Speaker left and right channel output: speaker cable (commonly known as gold and silver wire).
- 6、 OUT: To connect third-part amplifier.

## Remote Control Instuction

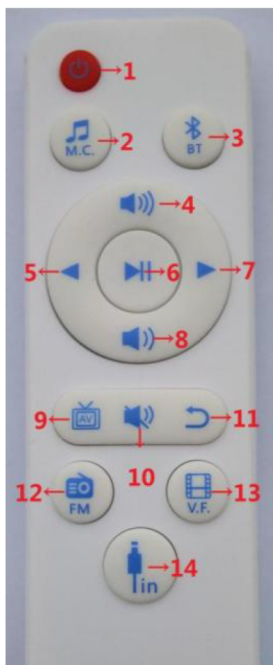

1. POWER SWITCH
2. MUSIC PLAY MODE
3. BLUETOOTH PLAY MODE
4. VOLUME +
5. PREVIOUS
6. STOP/PLAY
7. NEXT
8. VOLUME -
9. THIS IS ONLY FOR HIGH CLASS VERSION
10. MUTE
11. BACK
12. FM MODE
13. THIS IS ONLY FOR HIGH CLASS VERSION
14. CONNECT AUX PLSY MODE

# A5D Front Control Panel Instruction



1. PREVIOUS
2. PLAY/STOP/OK
3. NEXT
4. VOLUME -
5. VOLUME +
6. POWER ON/ POWER OFF/ BACK

## Installation & Mounting

The on wall amplifier can fit into a standard back box of 60mm depth or more (supplied). Adequate space for connections and ventilation should be ensured and a deeper back box may be beneficial.

Remove the front fascia of the on wall amplifier by carefully prizing it away from the main housing. A slot is visible on the right-hand side of the fascia which can be used to insert a screwdriver for this purpose.

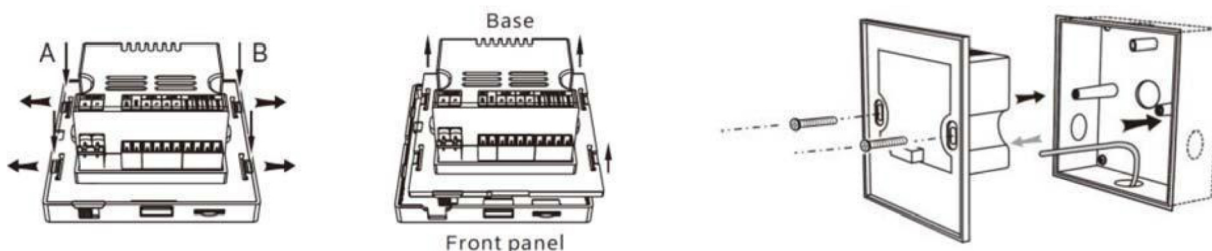

Removing the front fascia will reveal the mounting screw holes behind. These should be lined up with the threaded tabs inside the back box or used with screws that are suitable for the material if mounted directly into the wall.

## Fault resolution

The following checks will help you solve the problems you may encounter while using the machine. Before using the checklist below, check that the connections and procedures are correct.

Malfunction	Reasons and solutions
-------------	-----------------------

No display	<ol style="list-style-type: none"> <li>1. Check if the power cord is installed correctly.</li> <li>2. Check if the power switch is turned on.</li> <li>3. Check if the backlight time is set.</li> </ol>
No sound	<ol style="list-style-type: none"> <li>1. Check if the speaker cable is installed correctly.</li> <li>2. Check if mute is set.</li> </ol>
Button does not work	<ol style="list-style-type: none"> <li>1. Is the panel too dirty and there is no water in the button area? (If you have it, please clean it up and then operate it)</li> <li>2. Whether there is water on the hand during operation.</li> <li>3. Turn off the power and restart.</li> </ol>
Can't connect to Bluetooth	<ol style="list-style-type: none"> <li>1. Whether the host is connected to another device.</li> <li>2. Whether to search for Bluetooth devices is enabled on the mobile phone.</li> </ol>
No sound when connected to Bluetooth	<ol style="list-style-type: none"> <li>1. Whether the mobile terminal playback has been selected for Bluetooth playback. (Apple mobile phone needs to choose to play for Bluetooth devices)</li> <li>2. Whether the mobile terminal is set to mute.</li> <li>3. The host is not set to mute.</li> <li>4. Whether the song played on the mobile phone is a lossless format song. (This version of the host does not support lossless playback)</li> <li>5. The phone is too far away from the host.</li> </ol>
FM reception is not good	<ol style="list-style-type: none"> <li>1. The length of the radio signal antenna cannot be less than 2 meters.</li> <li>2. The direction of the radio signal antenna is not the best direction. (The radio signal antenna is best near the outdoor)</li> </ol>
FM can't receive radio on Tuesday afternoon	On Tuesday afternoon, major radio stations will stop broadcasting and carry out various maintenance work on the radio.
When the FM is playing, the display will not display	After 5 seconds of FM playback, it will automatically black out to ensure better reception. Users can press any button to brighten the screen.

If above method still fails to solve the problem, please go to the nearest supplier for assistance. Please donot disassemble the machine by yourself.

## Service

Ensure the problem is not related to operator error, or system devices that are external to this unit. Information provided in the troubleshooting portion of this manual may help with this process. Once it is certain that the problem is related to the product contact your warranty provider as described in the warranty section of this manual.

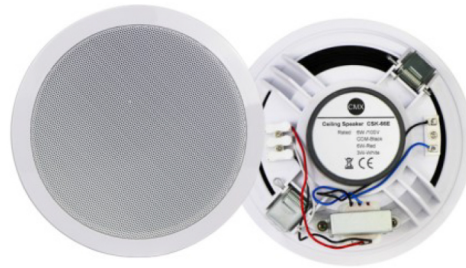

**Specification:**

Model	CSK-66ER
Description	6.5" Ceiling Speaker
Power Taps	6W@ 8ohm
Frequency Response	100-15KHz
SPL(@1W/m)	93±3dB
Speaker Unit	6.5" full range paper cone
Cutout Size	Ø 165mm
Dimension	Ø 188×76mm
Material	ABS enclosure and metal grille in white
Weight	0.7kg



## Warranty

Warranty terms of global three years. While the term and warranty may vary by country and may not be the same for all products. Terms and conditions of warranty for a given product may be determined first by locating the appropriate country which the product was purchased in, then by locating the product type.



**Disposal:** The “Crossed Wheelie Bin” symbol on the product means that the product is classed as Electrical or Electronic equipment and should not be disposed with other household or commercial waste at the end of its useful life. The goods must be disposed of according to your local council guidelines.